A long, modern office hallway with glass-walled rooms and a concrete ceiling with exposed beams and track lighting. The hallway is carpeted and has a clean, minimalist design. The glass walls of the rooms are framed in black, and the ceiling features a series of black track lights. The perspective is from the end of the hallway, looking down its length.

Sound as it's meant to be
BOWIQ provides acoustic comfort
seamlessly integrated into the design.

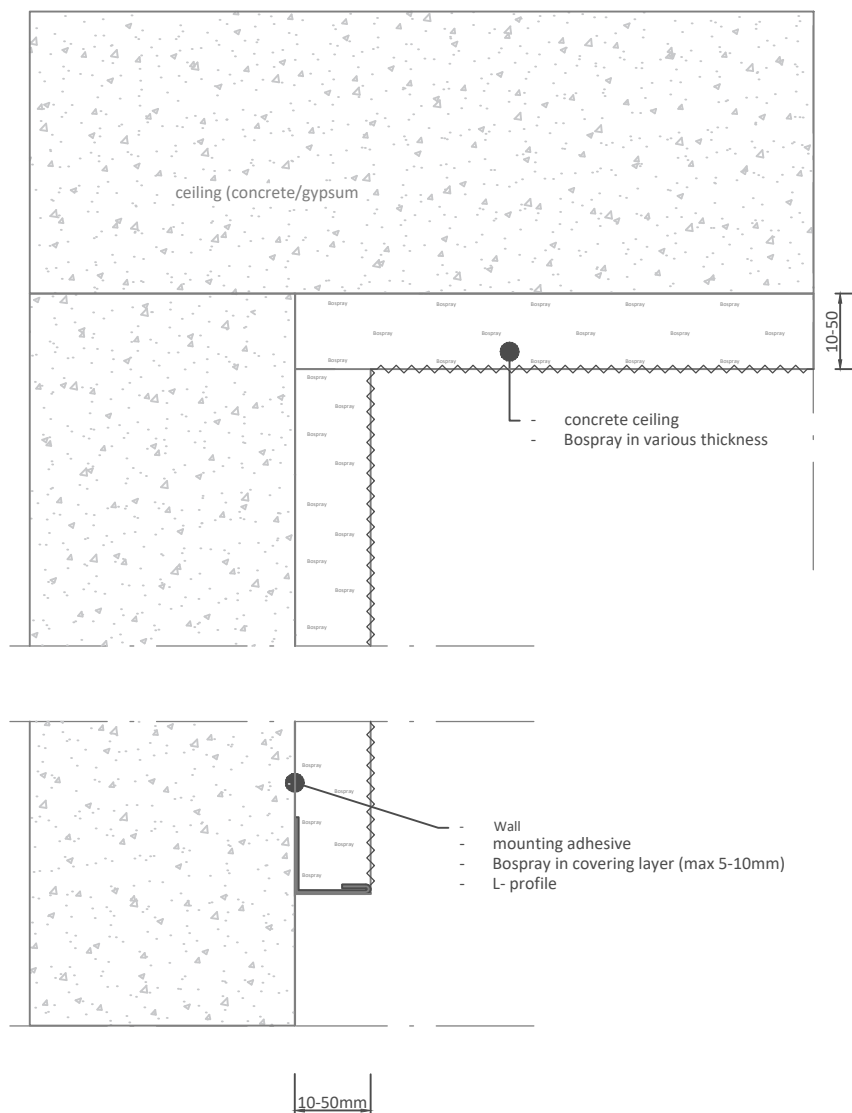

NOTE:

BoSpray must always be applied in accordance with Bowiq's installation guidelines. Application should take place on clean, dry, and dimensionally stable surfaces such as concrete, gypsum board or equivalent.

The dimensions of edge profiles and other accessories depend on the selected thickness of the BoSpray system.

Product: **BOSPRAY 10-50MM**

Scale: 1:2
Papersize: A4

Date: V1.0 2025

Drawn by: BOWIQ

info@bowiq.com

WWW.BOWIQ.COM

BOWIQ
beyond acoustics

**The illustrated details are indicative and serve as general design guidance only. They do not replace project-specific execution drawings.

The correct installation and application of the BoSpray system is the responsibility of the client or appointed contractor.

All measurements and site conditions must be verified prior to installation.

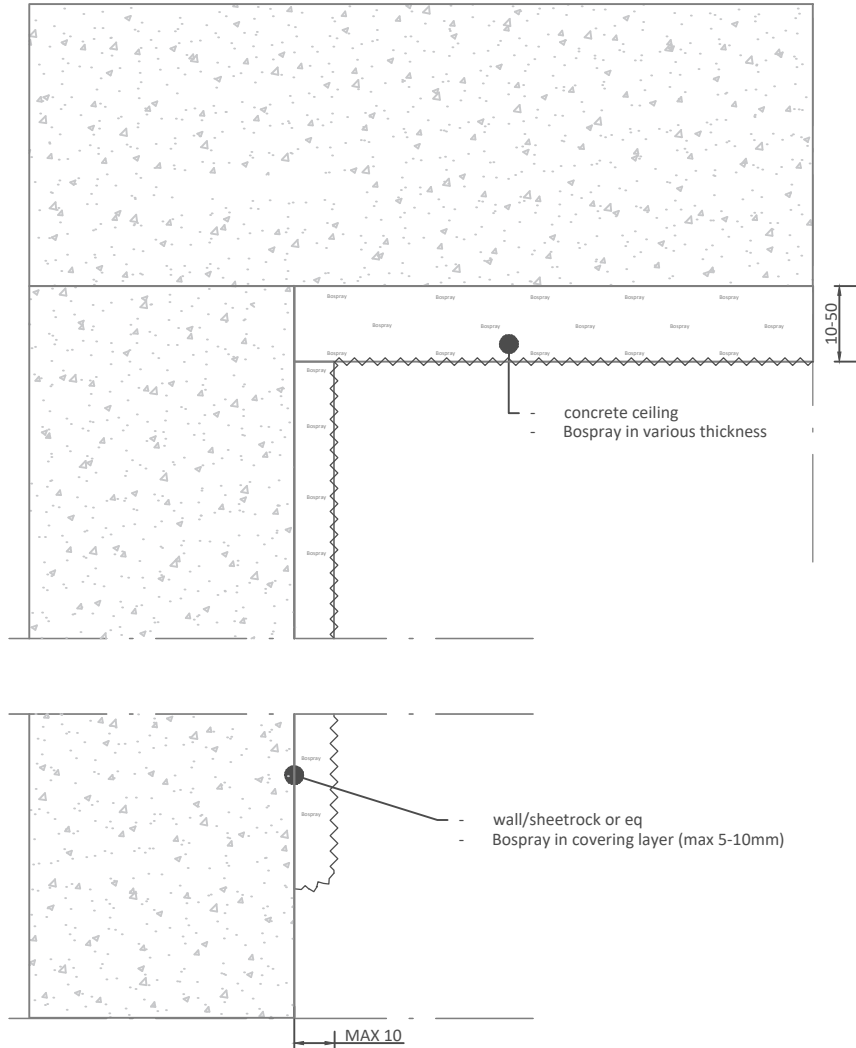

NOTE:

BoSpray must always be applied in accordance with Bowiq's installation guidelines. Application should take place on clean, dry, and dimensionally stable surfaces such as concrete, gypsum board or equivalent.

The dimensions of edge profiles and other accessories depend on the selected thickness of the BoSpray system.

Product: **BOSPRAY 10-50MM**

Scale: 1:2
Papersize: A4

Date: V1.0 2025
Drawn by: BOWIQ

info@bowiq.com

WWW.BOWIQ.COM

BOWIQ
beyond acoustics

**The illustrated details are indicative and serve as general design guidance only. They do not replace project-specific execution drawings.

The correct installation and application of the BoSpray system is the responsibility of the client or appointed contractor.

All measurements and site conditions must be verified prior to installation.

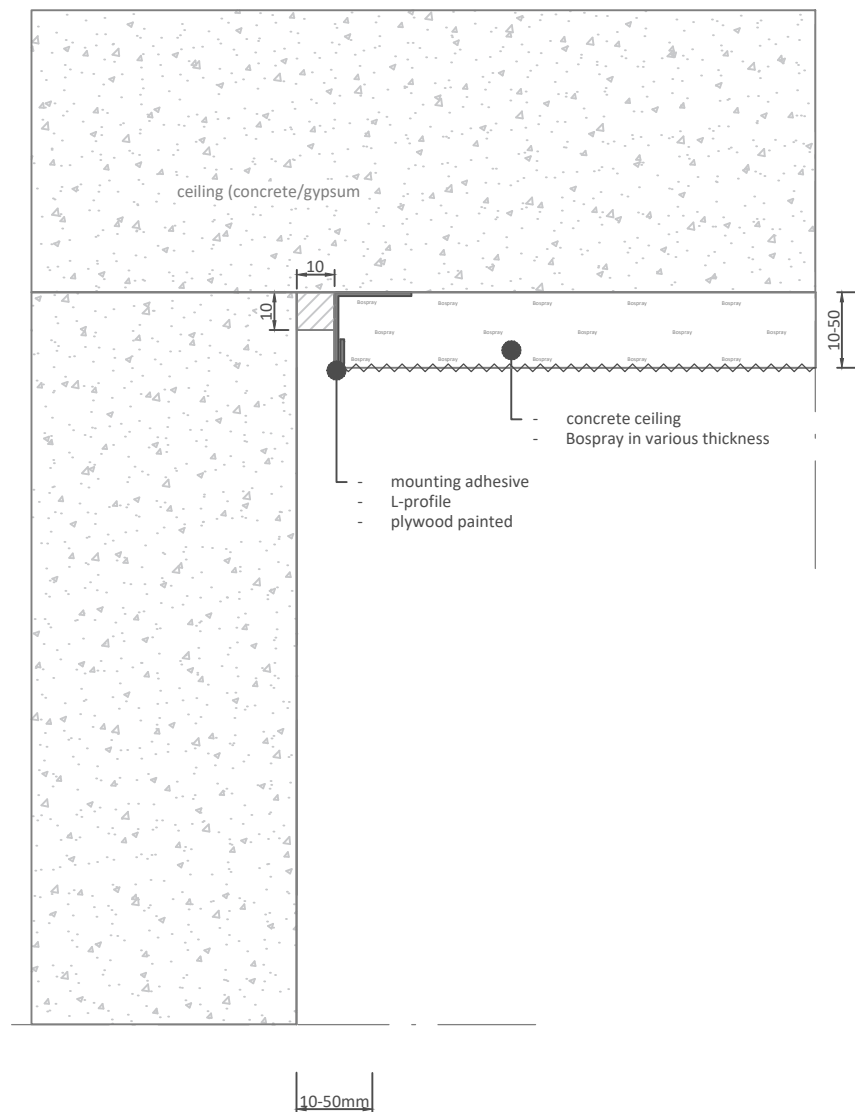

NOTE:

BoSpray must always be applied in accordance with Bowiq's installation guidelines. Application should take place on clean, dry, and dimensionally stable surfaces such as concrete, gypsum board or equivalent.

The dimensions of edge profiles and other accessories depend on the selected thickness of the BoSpray system.

Product: **BOSPRAY 10-50MM**

Scale: 1:2
Papersize: A4

Date: V1.0 2025
Drawn by: BOWIQ

info@bowiq.com

WWW.BOWIQ.COM

BOWIQ
beyond acoustics

**The illustrated details are indicative and serve as general design guidance only. They do not replace project-specific execution drawings.

The correct installation and application of the BoSpray system is the responsibility of the client or appointed contractor.

All measurements and site conditions must be verified prior to installation.

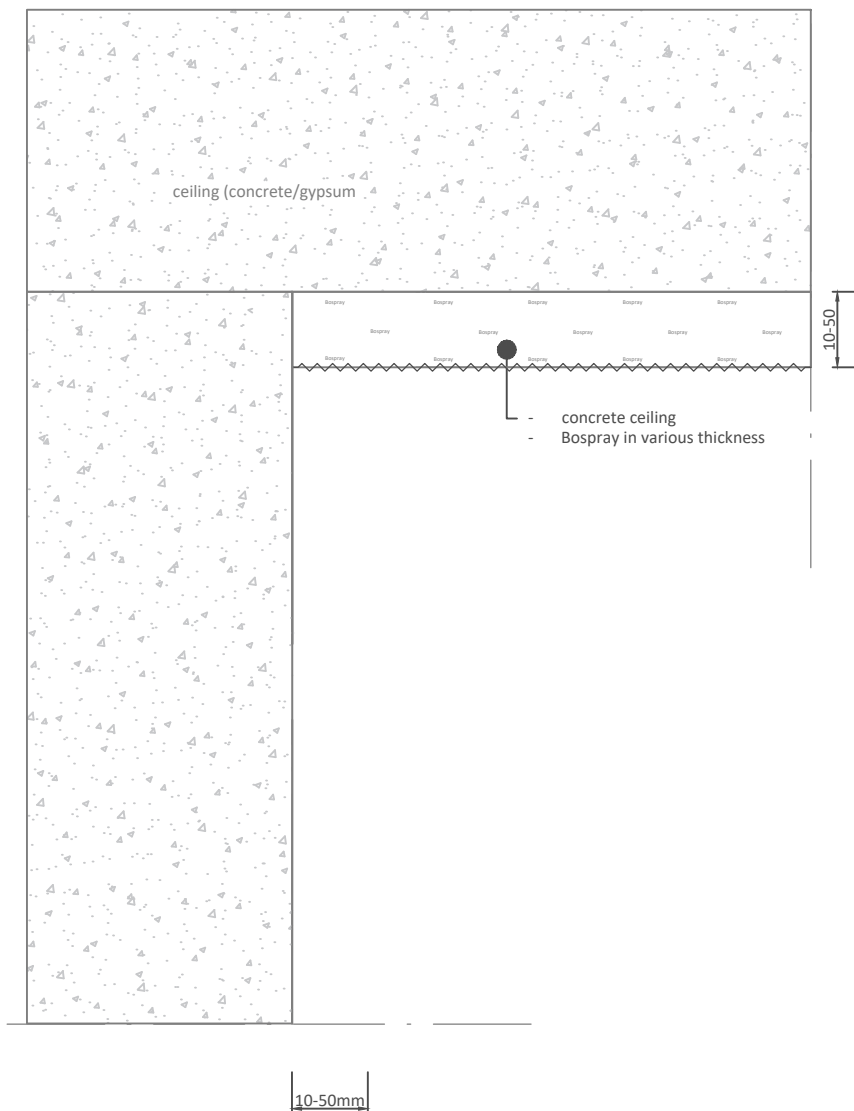

NOTE:

BoSpray must always be applied in accordance with Bowiq's installation guidelines. Application should take place on clean, dry, and dimensionally stable surfaces such as concrete, gypsum board or equivalent.

The dimensions of edge profiles and other accessories depend on the selected thickness of the BoSpray system.

Product: **BOSPRAY 10-50MM**

Scale: 1:2
Papersize: A4

Date: V1.0 2025
Drawn by: BOWIQ

info@bowiq.com

WWW.BOWIQ.COM

BOWIQ
beyond acoustics

**The illustrated details are indicative and serve as general design guidance only. They do not replace project-specific execution drawings.

The correct installation and application of the BoSpray system is the responsibility of the client or appointed contractor.

All measurements and site conditions must be verified prior to installation.

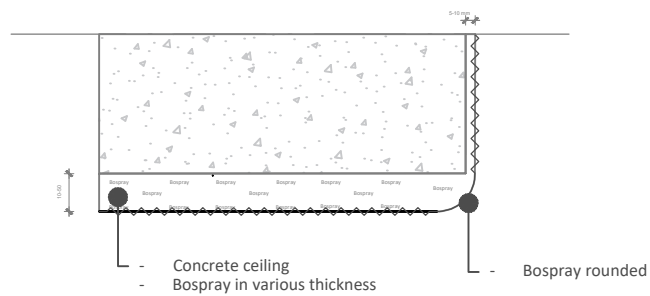

NOTE:

BoSpray must always be applied in accordance with Bowiq's installation guidelines. Application should take place on clean, dry, and dimensionally stable surfaces such as concrete, gypsum board or equivalent.

The dimensions of edge profiles and other accessories depend on the selected thickness of the BoSpray system.

Product: BOSPRAV 10-50MM

Scale: 1:2
Papersize: A4

Date: V1.0 2025
Drawn by: BOWIQ

info@bowiq.com

WWW.BOWIQ.COM

BOWIQ
beyond acoustics

**The illustrated details are indicative and serve as general design guidance only. They do not replace project-specific execution drawings.

The correct installation and application of the BoSpray system is the responsibility of the client or appointed contractor.

All measurements and site conditions must be verified prior to installation.

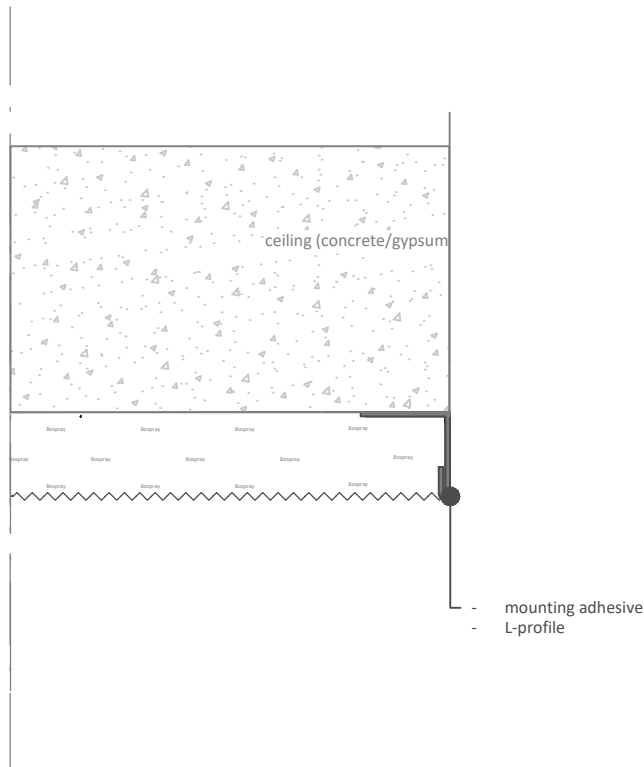

NOTE:

BoSpray must always be applied in accordance with Bowiq's installation guidelines. Application should take place on clean, dry, and dimensionally stable surfaces such as concrete, gypsum board or equivalent.

The dimensions of edge profiles and other accessories depend on the selected thickness of the BoSpray system.

Product: BOSPRAY 10-50MM

Scale: 1:2
Papersize: A4

Date: V1.0 2025

Drawn by: BOWIQ

info@bowiq.com

WWW.BOWIQ.COM

BOWIQ
beyond acoustics

**The illustrated details are indicative and serve as general design guidance only. They do not replace project-specific execution drawings. The correct installation and application of the BoSpray system is the responsibility of the client or appointed contractor. All measurements and site conditions must be verified prior to installation.

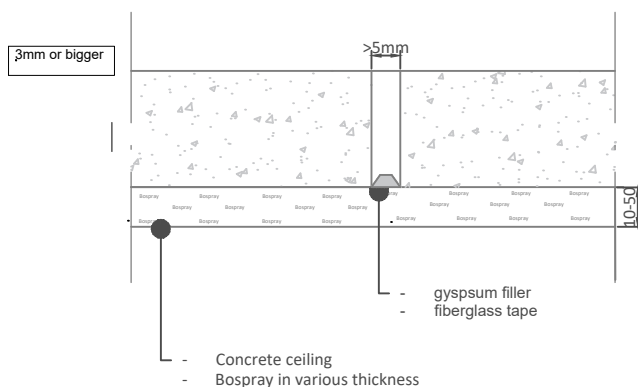
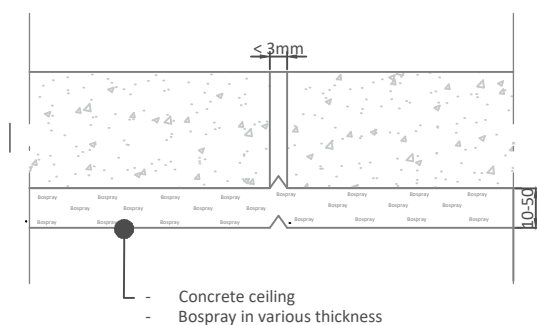

NOTE:

BoSpray must always be applied in accordance with Bowiq's installation guidelines. Application should take place on clean, dry, and dimensionally stable surfaces such as concrete, gypsum board or equivalent.

The dimensions of edge profiles and other accessories depend on the selected thickness of the BoSpray system.

Product: BOSPRAY 10-50MM

Scale: 1:2
Papersize: A4

Date: V1.0 2025

Drawn by: BOWIQ

info@bowiq.com

WWW.BOWIQ.COM

BOWIQ
beyond acoustics

**The illustrated details are indicative and serve as general design guidance only. They do not replace project-specific execution drawings.

The correct installation and application of the BoSpray system is the responsibility of the client or appointed contractor.

All measurements and site conditions must be verified prior to installation.

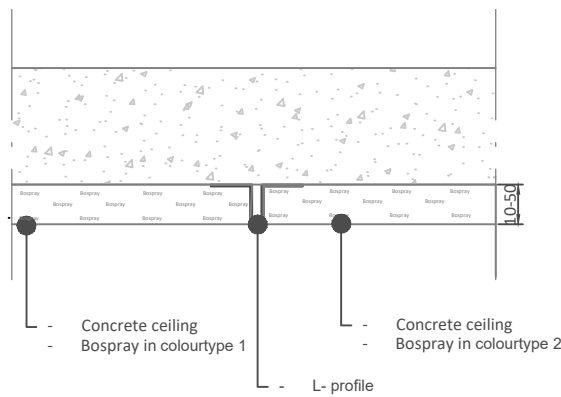

NOTE:

BoSpray must always be applied in accordance with Bowiq's installation guidelines. Application should take place on clean, dry, and dimensionally stable surfaces such as concrete, gypsum board or equivalent.

The dimensions of edge profiles and other accessories depend on the selected thickness of the BoSpray system.

Product: **BOSPRAY 10-50MM**

Scale: 1:2
Papersize: A4

Date: V1.0 2025

Drawn by: BOWIQ

info@bowiq.com

WWW.BOWIQ.COM

BOWIQ
beyond acoustics

**The illustrated details are indicative and serve as general design guidance only. They do not replace project-specific execution drawings.

The correct installation and application of the BoSpray system is the responsibility of the client or appointed contractor.

All measurements and site conditions must be verified prior to installation.

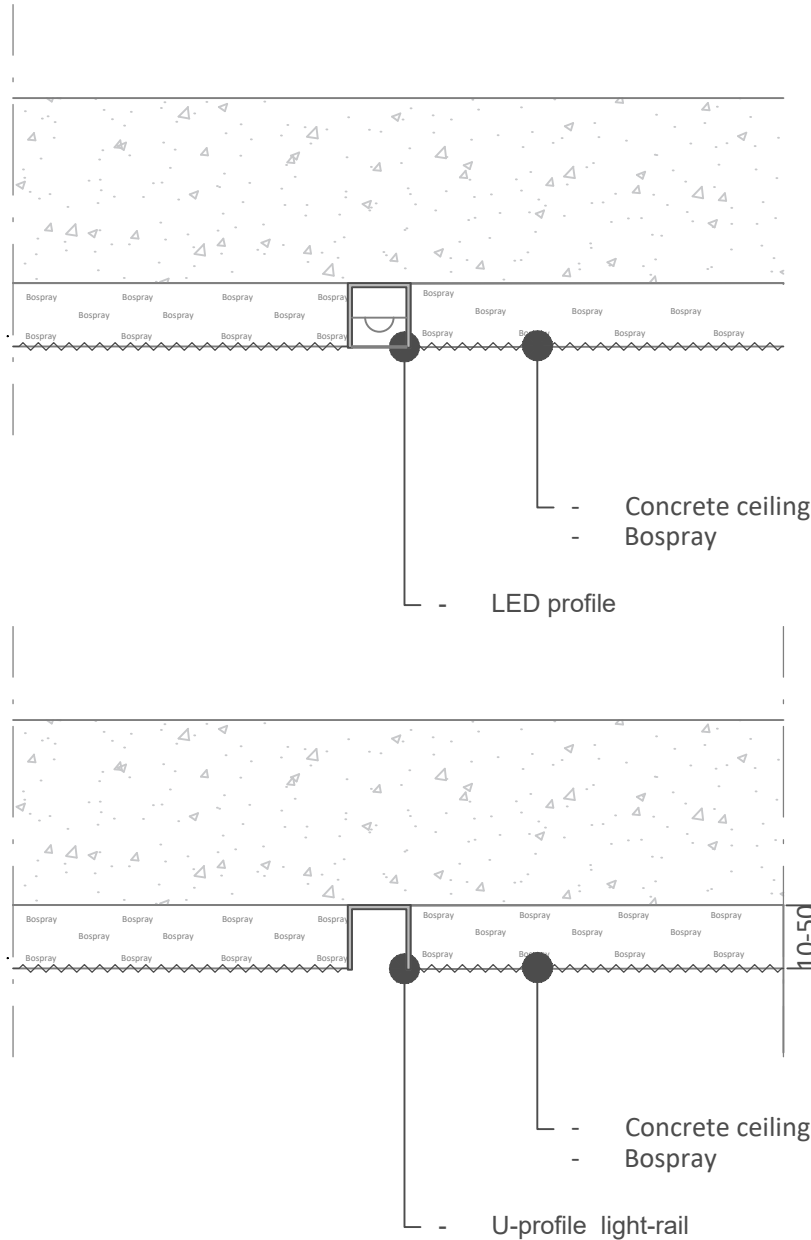

NOTE:

BoSpray must always be applied in accordance with Bowiq's installation guidelines. Application should take place on clean, dry, and dimensionally stable surfaces such as concrete, gypsum board or equivalent.

The dimensions of edge profiles and other accessories depend on the selected thickness of the BoSpray system.

Product: **BOSPRAY 10-50MM**

Scale: 1:2
Papersize: A4

Date: V1.0 2025
Drawn by: BOWIQ

info@bowiq.com

WWW.BOWIQ.COM

BOWIQ
beyond acoustics

**The illustrated details are indicative and serve as general design guidance only. They do not replace project-specific execution drawings.

The correct installation and application of the BoSpray system is the responsibility of the client or appointed contractor.

All measurements and site conditions must be verified prior to installation.

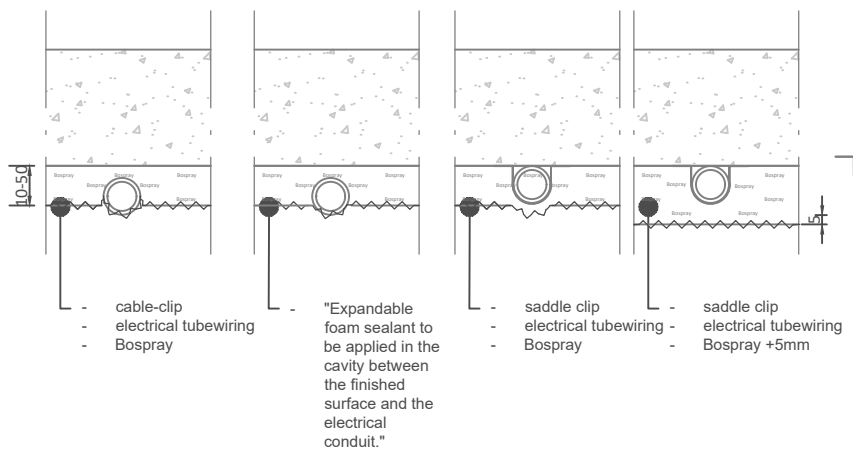

"To be specified by the architect and client before execution of works"

NOTE:

BoSpray must always be applied in accordance with Bowiq's installation guidelines. Application should take place on clean, dry, and dimensionally stable surfaces such as concrete, gypsum board or equivalent.

The dimensions of edge profiles and other accessories depend on the selected thickness of the BoSpray system.

Product: **BOSPRAY 10-50MM**

Scale: 1:2
Papersize: A4

Date: V1.0 2025
Drawn by: BOWIQ

info@bowiq.com

WWW.BOWIQ.COM

BOWIQ
beyond acoustics

**The illustrated details are indicative and serve as general design guidance only. They do not replace project-specific execution drawings.

The correct installation and application of the BoSpray system is the responsibility of the client or appointed contractor.

All measurements and site conditions must be verified prior to installation.

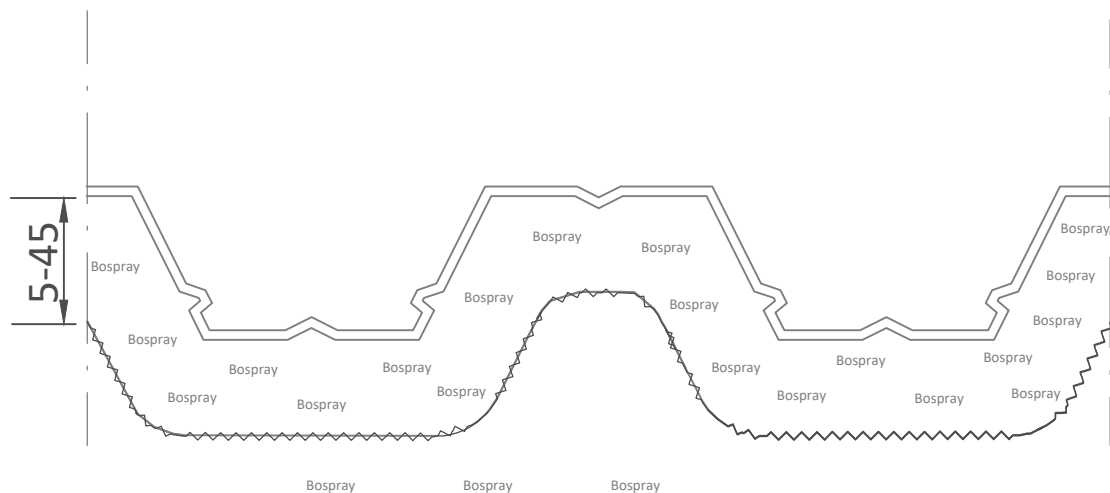

NOTE:

BoSpray must always be applied in accordance with Bowiq's installation guidelines. Application should take place on clean, dry, and dimensionally stable surfaces such as concrete, gypsum board or equivalent.

The dimensions of edge profiles and other accessories depend on the selected thickness of the BoSpray system.

Product: **BOSPRAY 10-50MM**

Scale: 1:2
Papersize: A4

Date: V1.0 2025
Drawn by: BOWIQ

info@bowiq.com

WWW.BOWIQ.COM

BOWIQ
beyond acoustics

**The illustrated details are indicative and serve as general design guidance only. They do not replace project-specific execution drawings.

The correct installation and application of the BoSpray system is the responsibility of the client or appointed contractor.

All measurements and site conditions must be verified prior to installation.

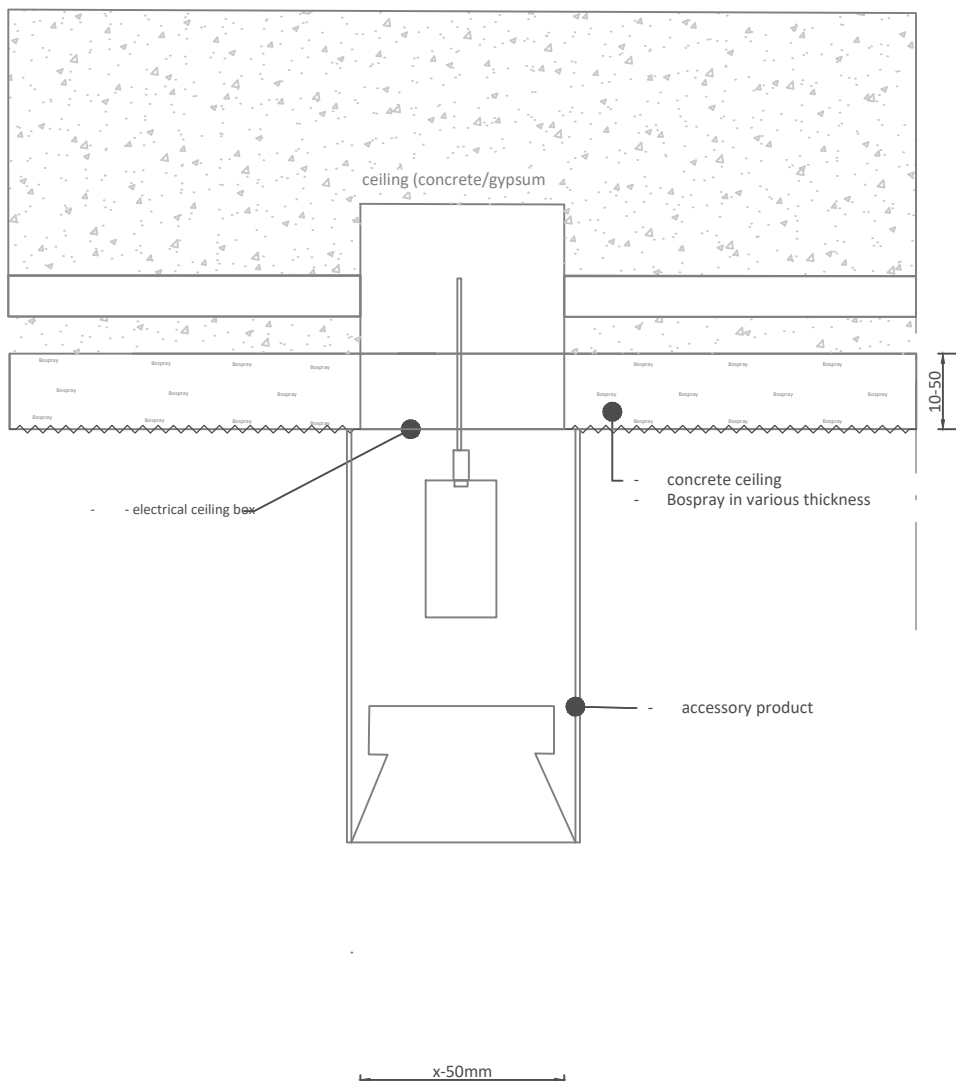

NOTE:

BoSpray must always be applied in accordance with Bowiq's installation guidelines. Application should take place on clean, dry, and dimensionally stable surfaces such as concrete, gypsum board or equivalent.

The dimensions of edge profiles and other accessories depend on the selected thickness of the BoSpray system.

Product: **BOSPRAY 10-50MM**

Scale: 1:2
Papersize: A4

Date: V1.0 2025
Drawn by: BOWIQ

info@bowiq.com

WWW.BOWIQ.COM

BOWIQ
beyond acoustics

**The illustrated details are indicative and serve as general design guidance only. They do not replace project-specific execution drawings.

The correct installation and application of the BoSpray system is the responsibility of the client or appointed contractor.

All measurements and site conditions must be verified prior to installation.

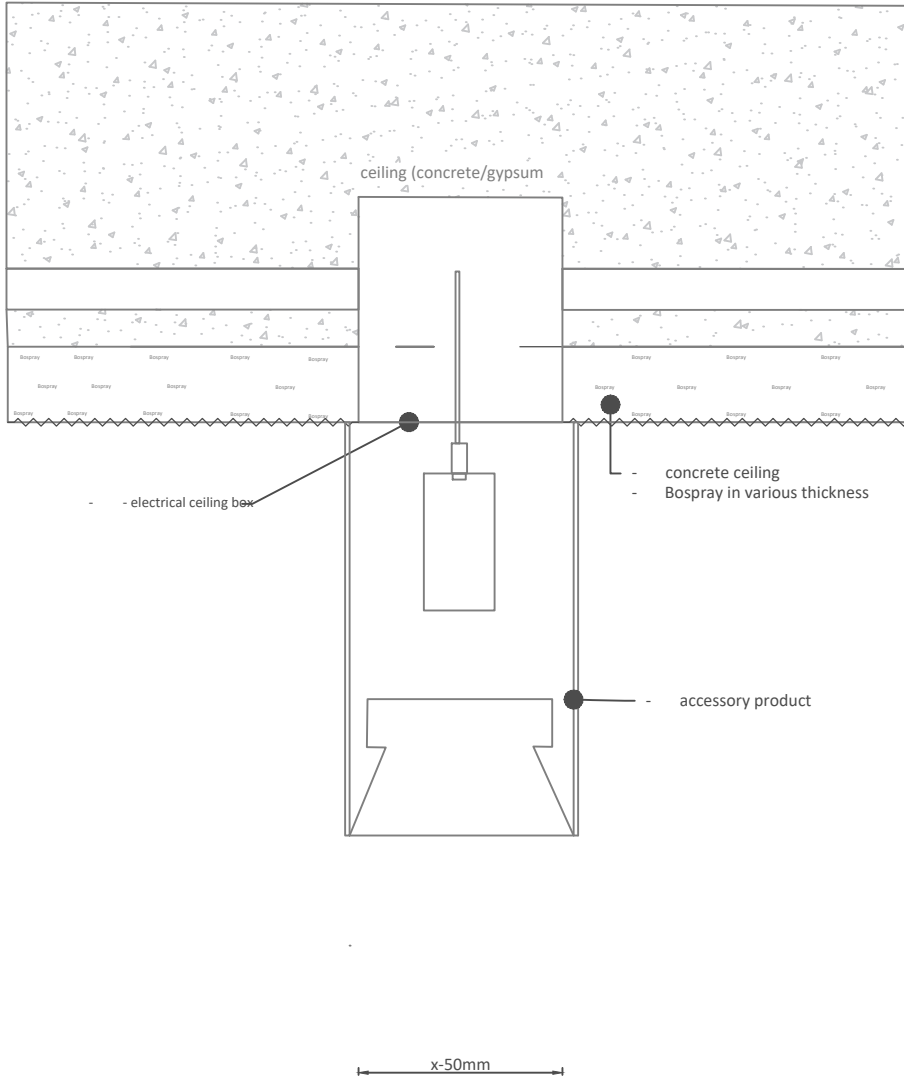

NOTE:

BoSpray must always be applied in accordance with Bowiq's installation guidelines. Application should take place on clean, dry, and dimensionally stable surfaces such as concrete, gypsum board or equivalent.

The dimensions of edge profiles and other accessories depend on the selected thickness of the BoSpray system.

Product: **BOSPRAY 10-50MM**

Scale: 1:2
Papersize: A4

Date: V1.0 2025
Drawn by: BOWIQ

info@bowiq.com

WWW.BOWIQ.COM

BOWIQ
beyond acoustics

**The illustrated details are indicative and serve as general design guidance only. They do not replace project-specific execution drawings. The correct installation and application of the BoSpray system is the responsibility of the client or appointed contractor. All measurements and site conditions must be verified prior to installation.

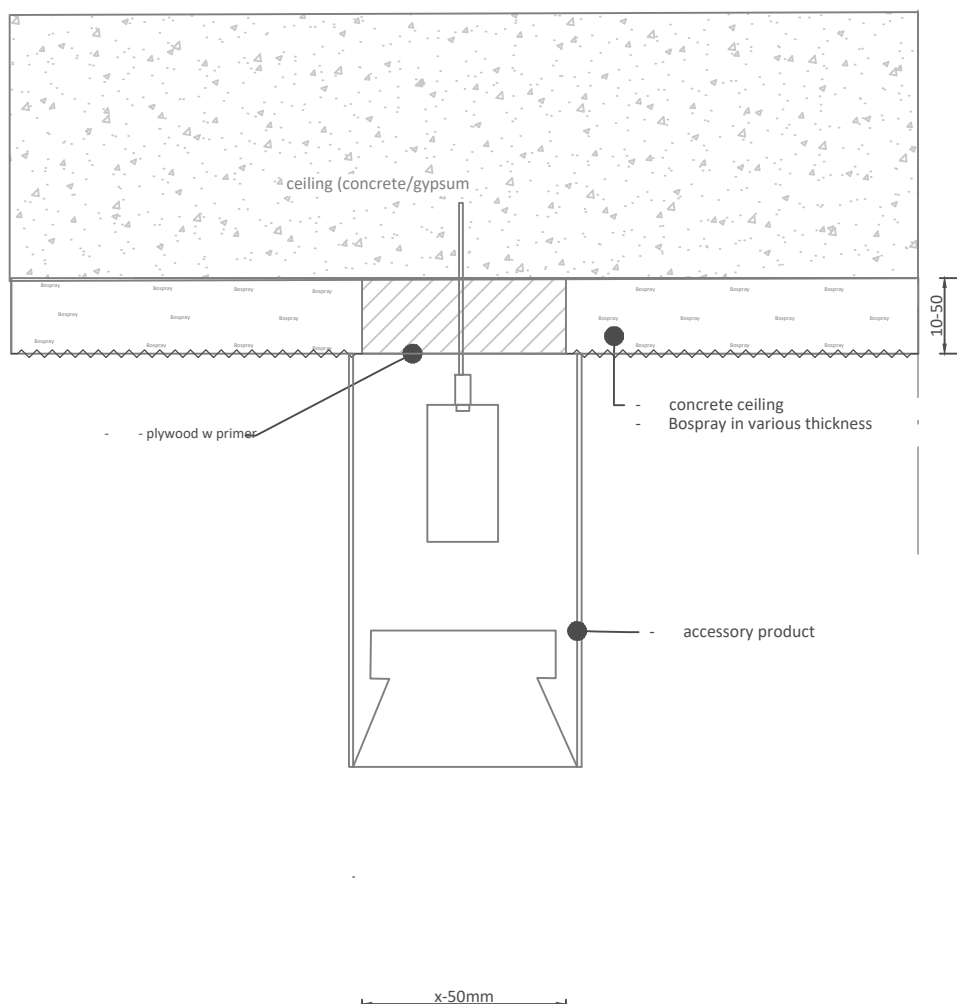

NOTE:

BoSpray must always be applied in accordance with Bowiq's installation guidelines. Application should take place on clean, dry, and dimensionally stable surfaces such as concrete, gypsum board or equivalent.

The dimensions of edge profiles and other accessories depend on the selected thickness of the BoSpray system.

Product: BOSPRAY 10-50MM

Scale: 1:2
Papersize: A4

Date: V1.0 2025

Drawn by: BOWIQ

info@bowiq.com

WWW.BOWIQ.COM

BOWIQ
beyond acoustics

**The illustrated details are indicative and serve as general design guidance only. They do not replace project-specific execution drawings.

The correct installation and application of the BoSpray system is the responsibility of the client or appointed contractor.

All measurements and site conditions must be verified prior to installation.

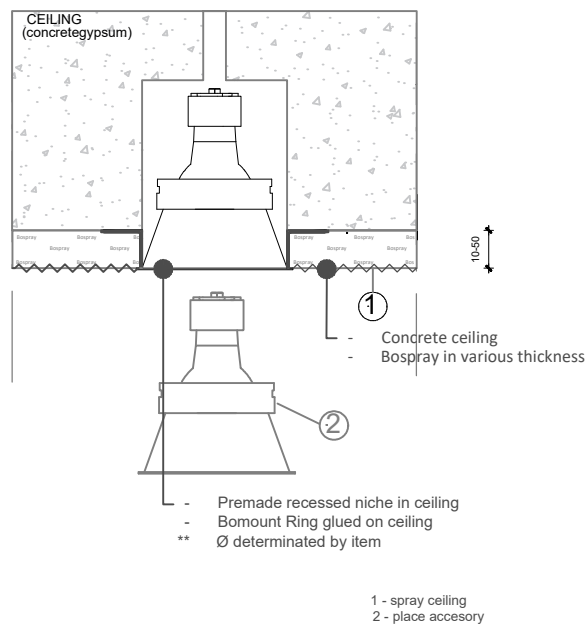

NOTE:

BoSpray must always be applied in accordance with Bowiq's installation guidelines. Application should take place on clean, dry, and dimensionally stable surfaces such as concrete, gypsum board or equivalent.

The dimensions of edge profiles and other accessories depend on the selected thickness of the BoSpray system.

Product: BOSPRAY 10-50MM

Scale: 1:2
Papersize: A4

Date: V1.0 2025
Drawn by: BOWIQ

info@bowiq.com

WWW.BOWIQ.COM

BOWIQ
beyond acoustics

**The illustrated details are indicative and serve as general design guidance only. They do not replace project-specific execution drawings. The correct installation and application of the BoSpray system is the responsibility of the client or appointed contractor. All measurements and site conditions must be verified prior to installation.

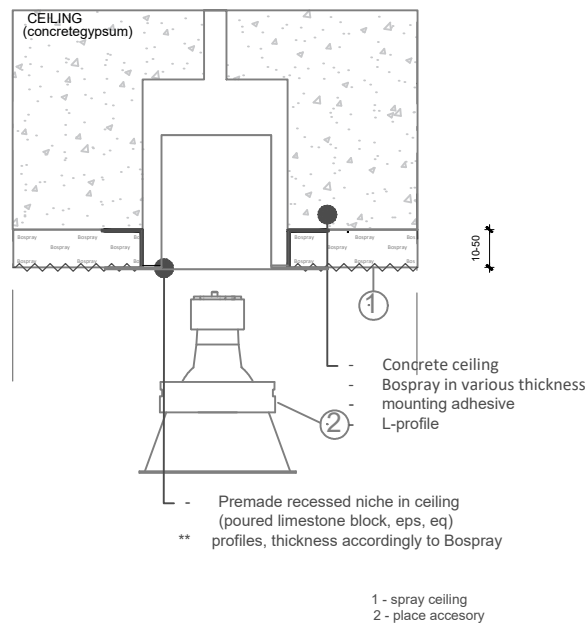

NOTE:

BoSpray must always be applied in accordance with Bowiq's installation guidelines. Application should take place on clean, dry, and dimensionally stable surfaces such as concrete, gypsum board or equivalent.

The dimensions of edge profiles and other accessories depend on the selected thickness of the BoSpray system.

Product: **BOSPRAY 10-50MM**

Scale: 1:2
Papersize: A4

Date: V1.0 2025
Drawn by: BOWIQ

info@bowiq.com

WWW.BOWIQ.COM

BOWIQ
beyond acoustics

**The illustrated details are indicative and serve as general design guidance only. They do not replace project-specific execution drawings. The correct installation and application of the BoSpray system is the responsibility of the client or appointed contractor. All measurements and site conditions must be verified prior to installation.

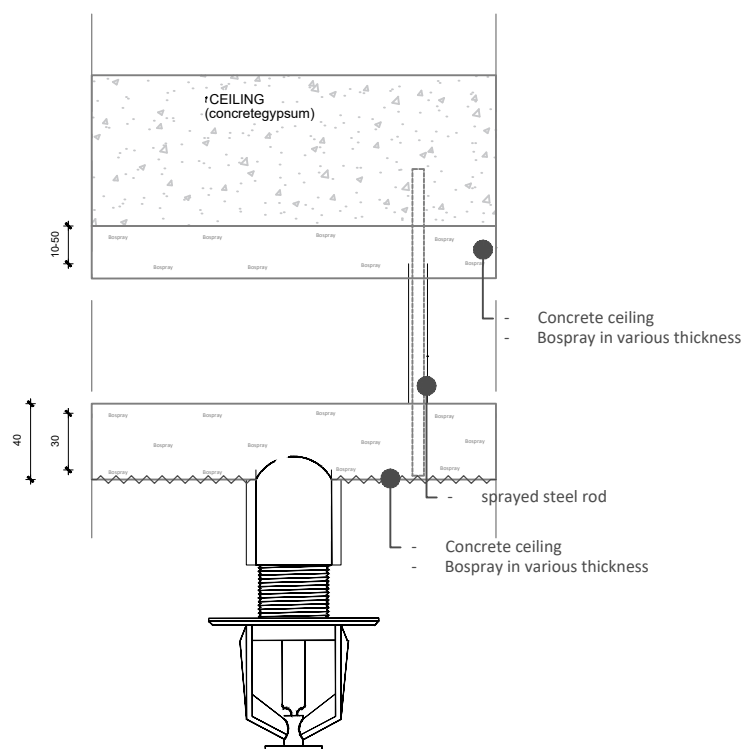

NOTE:

BoSpray must always be applied in accordance with Bowiq's installation guidelines. Application should take place on clean, dry, and dimensionally stable surfaces such as concrete, gypsum board or equivalent.

The dimensions of edge profiles and other accessories depend on the selected thickness of the BoSpray system.

Product: **BOSPRAY 10-50MM**

Scale: 1:2
Papersize: A4

Date: V1.0 2025
Drawn by: BOWIQ

info@bowiq.com

WWW.BOWIQ.COM

BOWIQ
beyond acoustics

**The illustrated details are indicative and serve as general design guidance only. They do not replace project-specific execution drawings. The correct installation and application of the BoSpray system is the responsibility of the client or appointed contractor. All measurements and site conditions must be verified prior to installation.

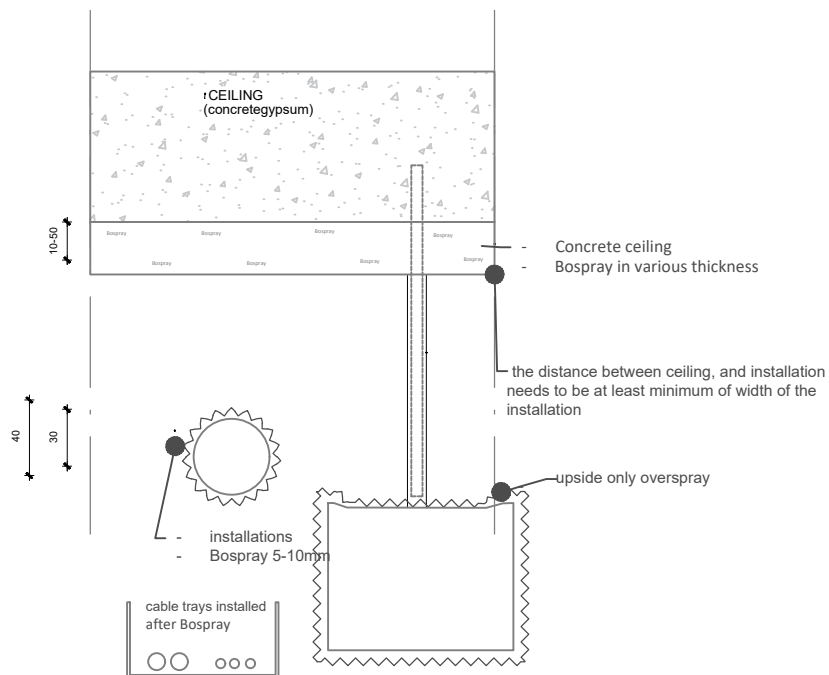

INSTALLATIONS

NOTE:

BoSpray must always be applied in accordance with Bowiq's installation guidelines. Application should take place on clean, dry, and dimensionally stable surfaces such as concrete, gypsum board or equivalent.

The dimensions of edge profiles and other accessories depend on the selected thickness of the BoSpray system.

Product: **BOSPRAY 10-50MM**

Scale: 1:2
Papersize: A4

Date: V1.0 2025
Drawn by: BOWIQ

info@bowiq.com

WWW.BOWIQ.COM

BOWIQ
beyond acoustics

**The illustrated details are indicative and serve as general design guidance only. They do not replace project-specific execution drawings.

The correct installation and application of the BoSpray system is the responsibility of the client or appointed contractor.

All measurements and site conditions must be verified prior to installation.

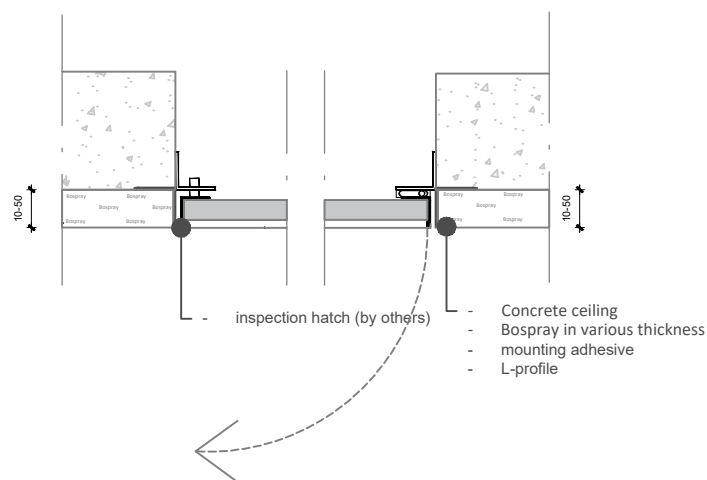

NOTE:

BoSpray must always be applied in accordance with Bowiq's installation guidelines. Application should take place on clean, dry, and dimensionally stable surfaces such as concrete, gypsum board or equivalent.

The dimensions of edge profiles and other accessories depend on the selected thickness of the BoSpray system.

Product: **BOSPRAY 10-50MM**

Scale: 1:2
Papersize: A4

Date: V1.0 2025
Drawn by: BOWIQ

info@bowiq.com

WWW.BOWIQ.COM

BOWIQ
beyond acoustics

**The illustrated details are indicative and serve as general design guidance only. They do not replace project-specific execution drawings.

The correct installation and application of the BoSpray system is the responsibility of the client or appointed contractor.

All measurements and site conditions must be verified prior to installation.

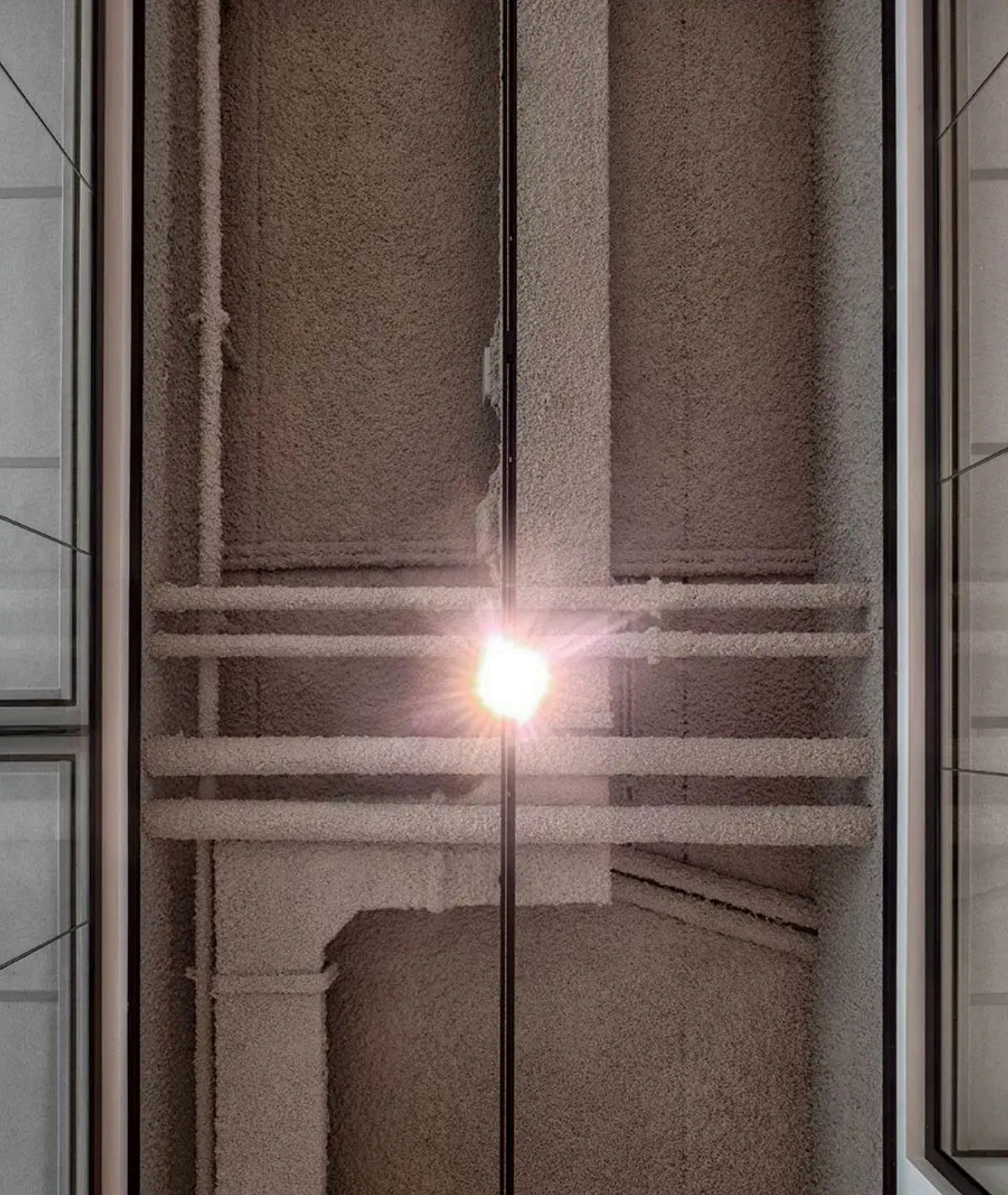

Office North America
Bowiq Nort America LLC
16192 Coastal Highway, Lewes, DE 19958, USA
+1 302 703 7600

Office Europe
Bowiq Benelux BV
Hullenbergweg 278
1101 BV Amsterdam, Netherlands
+3197010209735
Info@bowiq.com

Office Middle East & Asia
Bowiq Building Solotions Ltd
13A Jalan Pinang Utama Beverly row
Bungalows IOI Resort
62502 Putrajaya, Malaysia
+60137811670
Cs@bowiq.com

BOWIQ
beyond acoustics